

# YOLDAŞ

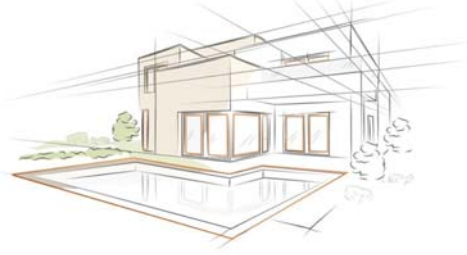

## Elastic NP1® Construction

NP1 Construction is a one component MS polymer-based adhesive and insulation material that cures with the humid air.

### PROPERTIES

- Waterproof
- Jointing and gluing
- Paintable with most water and solvent based paints
- Bonds without primer to almost all materials used in construction industry
- Excellent UV and weather resistance
- Bonds slightly moist surfaces
- Solvent- and isocyanate-free
- Does not cause any corrosion on metals
- Extremely strong and permanently elastic
- No discoloration
- No loss of volume and bubble formation
- Good resistance to bacteria and fungi
- Odourless

### APPLICATION AREAS

- Construction materials such as aluminum, galvanized and stainless steel, zinc, copper, HPL panels, glass, natural stones, various synthetic materials, etc.
- For interior and exterior use
- Universal sealant for horizontal and vertical moving gaps and expansion joint up to 50 mm width
- Adhesive sealant in car, caravan, train, bus construction, containers, and airconditioning installations
- Jointing and gluing work in veranda's, bathrooms, kitchens etc.
- All jointing where flexibility is important. Sealing between frame and wall, connecting joints of window/door frames, in facades and shop fronts
- Sound proofing between concrete and drain pipes
- Attaching and sealing of skirting boards, steps, doorsteps, protective profiles, fixing of covers, prefabric elements



### COLOR CHART



WHITE



CREAM



LIMESTONE



ALUMINUM  
GREY



TAN



REDWOOD  
TAN



TERRACOTTA



ANTHRACITE



BLACK



[www.yoldasgrup.com](http://www.yoldasgrup.com)



## MAY 605

### UNIVERSAL SILICONE



MAY 605 UNIVERSAL SILICONE is an acid-curing, one-component silicone sealant for a range of general sealing and glazing applications. It provides a strong adhesion and suitable for use on common non-porous building materials.

- Stays permanently elastic after curing.
- Acetoxy curing system.
- Mold-proof.
- Excellent adhesion to non-porous surfaces.
- Resistance to aging, cracking and discoloring.
- Resistant to many chemicals, cleaning agents and detergents.
- Can be applied in any season.
- Typical acetic smell during curing.

#### APPLICATION AREAS

- General sealing and glazing applications
- Sealing around windows and doors for insulation and gap filling.
- Sealing in DIY applications
- On bathroom, kitchen and plumbing applications.
- Connection and expansion joints on glass, porcelain, steel etc.
- Sealing electric, telephone etc. sockets and switches.

## MAY 804

### CONSTRUCTION SILICONE



MAY 804 CONSTRUCTION SILICONE is a premium performance neutral cure silicone sealant specially developed for weather sealing and glazing applications in curtain wall and building facades. It forms a strong weatherproof seal on common building materials.

- Neutral cure.
- Suitable for use on most common porous and non-porous building materials.
- It will not react with or corrode common building materials.
- Not affected by exposure to sunlight, rain, snow and maintains this resistance over many years.
- Resistant to temperature extremes.
- 100% Silicone, solventless.
- Almost odourless.
- Fast curing.

#### APPLICATION AREAS

- General weather sealing and glazing in building and curtain wall facades.
- Sealing of window frames.
- Mounting of window frames and doors.
- Sealing applications of marble, stone and other porous substrates.
- Sealing of connection and expansion joints.

## MAY 705

### ACRYLIC SEALANT



MAY 705 Acrylic Sealant is one-component universal acrylic sealant suitable for filling cracks and joints both indoors and outdoors. It's a cost-effective plastic-elastic sealant ideal for particularly static joints.

- Over paintable
- Can be used on all porous surfaces such as brick, concrete, wood etc.
- Very easy to apply and clean
- Water-proof after curing
- Odourless

#### APPLICATION AREAS

- Sealing of low movement joints between various construction materials (wood, concrete, brick etc.)
- Filling cracks in walls and on ceilings.
- Sealing joints between windows, walls, doors etc.

## MAY 620

### RED HIGH TEMPERATURE SILICONE



MAY 620 RED HIGH TEMPERATURE SILICONE is a high-performance silicone sealant developed for sealing, bonding and repairing works where heat resistance is required. It is an ideal sealant for high temperature construction applications. It reacts with atmospheric moisture to produce a tough, elastic sealant.

- Excellent heat resistance after curing up to 250°C permanently and up to 300°C temporarily.
- Acetoxy cure, RTV silicone.
- 100% silicone.
- Fast cure, high strength.
- Resists to mechanical enforcement after curing.
- Remains flexible at low (-40°C) and high (+250°C) temperatures.
- Will not crack, shrink or become brittle.
- One component.

#### APPLICATION AREAS

- Sealing and bonding applications in automobiles
- On heating systems and ovens for sealing/tightness
- Sealing and bonding in stoves
- In heating devices
- Gaskets in pumps and motors
- In sealing chimneys
- Other bonding and sealing applications where parts must perform at high temperatures

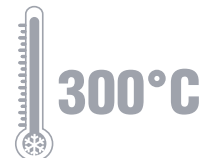

## MAY 702

### SILICONIZED ACRYLIC SEALANT



MAY 702 Siliconized Acrylic Sealant is one-component acrylic emulsion based sealant reinforced with silicone emulsion. It has superior adhesion and good elasticity.

- Can be used on all porous surfaces such as brick, concrete wood etc.
- Very easy to apply and clean
- Water-proof after curing
- Over paintable
- Odourless

#### APPLICATION AREAS

- Sealing of low and medium movement joints between various construction materials (wood, concrete, brick etc.)
- Sealing joints between windows, walls, doors etc.
- Filling cracks in walls and on ceilings.

**MAY 800**



### UNIVERSAL CYANOACRYLATE FAST ADHESIVE

MAY 800 UNIVERSAL CYANOACRYLATE FAST ADHESIVE is an adhesive set which consists of high viscosity cyanoacrylate adhesive and activator.

- High bonding strength.
- Suitable for use on vertical surfaces, it will not drip or slump.
- It is particularly suited for bonding difficult substrates which have porous or uneven surfaces.

#### APPLICATION AREAS

- It is suitable for bonding of a wide range of materials, including acidic surfaces and some porous ones, where rapid bonding times are required.
- Suitable for MDF, wood, chip wood, rubber, most plastics, leather and other common substrates.

**MAY 900**

**MAY 910**



PU FOAM

PU GUN FOAM

### PU FOAM

MAY 900 POLYURETHANE FOAM is a single-component, moisture-curing and self-expanding polyurethane foam. It is designed for easy dispensing through the straw adapter included with each can. It does not contain any propellant gases that are harmful to the ozone layer.

- Excellent adhesion & filling capacity and high thermal & acoustical insulation value.
- Good for filling wide gaps with its high expansion rate.
- Economical consumption thanks to precise application.
- High yield up to 45 liters depending on temperature and humidity.
- Mould-proof, water-proof and over paintable.
- MAY 910 comes with gun adaptor for precise use.

#### APPLICATION AREAS

- Filling and sealing of especially wider gaps, joints and cavities.
- Fixing and insulating of door and window frames.
- Filling of penetrations in walls.
- Insulating electrical outlets and water pipes.

### MONTAGE IS ADHESIVE

**MAY 600**



MAY 600 MONTAGE ADHESIVE is a single component, fast curing polyurethane based adhesive. It combines high bond strength with fast curing. The water resistance property makes it exceptionally good at bonding wooden surfaces where water splash and moisture is an issue.

- Fast curing, low press time.
- Extremely high bond strength on wooden substrates.
- Thixotropic, non-sag, ideal for vertical joints.
- Low consumption, economical.
- Usable on slightly wet substrates.
- Very good resistance to chemicals.
- Excellent resistance to moisture and weather conditions.
- Good filling properties.
- Non-shrinking.
- Low odor.

#### APPLICATION AREAS

- It is suitable for use in construction and repair applications where permanently strong bonds required between porous and nonporous surfaces.
- Bonding wooden surfaces at bathroom, kitchens, decks etc. where there is a constant moisture and water contact risk.
- It can be used for bonding various kinds of construction materials such as wood, MDF, concrete, metal, polystyrene and polyurethane foam, marble, granite and ceramic etc.

**MAY 920**

### MARINE ADHESIVE

MAY 920 MARINE ADHESIVE is a one-component, fast curing liquid polyurethane adhesive.

It possesses high water resistance and bonding strength.

- Easy application, low viscosity
- High bond strength
- Fast curing
- Can be used on slightly humid surfaces
- Resistant to temperature extremes
- Resistant to moisture and chemicals

#### APPLICATION AREAS

- Fixing and gluing wooden elements to other various porous and non-porous elements as wood, metal, concrete, polystyrene foam etc.
- Furniture and boat production.
- Fixing of raised flooring layings in combination with mechanical fixtures.
- All bonding applications that need a high water resistance.





# YOLDAŞ

## MEMO CHEM



### CHEMICAL ANCHOR

The product is a 2-component reaction resin mortar based on an epoxy acrylate resin and will be delivered in a 2-C cartridge (ST – standard cartridge) system. It was designed as a cost-effective alternative for the anchoring of threaded rods and internal threaded rod sleeves.

- Easy and safe application in hollow bricks and walls
- Overhead application
- Suitable for attachment points close to the edge, since anchoring is free of expansion forces
- revised chemical resistance
- low shrinkage
- high bending- and pressure strength
- Cartridge can be reused up to the end of the shelf life by replacing the static mixer or resealing cartridge with the screw cap
- Heat resistant. Can be used up to 80 °C
- Mechanical properties acc. to EN 196 Part 1
- + Density: 1,68 kg/dm<sup>3</sup>
- + Compressive strength: 121 N/mm<sup>2</sup>
- + Bending strength: 59 N/mm<sup>2</sup>
- + Dynamic modulus of elasticity: 3500 N/mm<sup>2</sup>

### APPLICATION AREAS

- Resistant to chlorine and various chemicals. Suitable for swimming pools.
- Roof
- Wood construction
- Metal Construction
- Metal Profiles
- Console
- Railing
- Sanitary devices
- Cable Trays
- Piping

## MAY CHEM



### CHEMICAL ANCHOR

- Cures and sets rapidly
- High mechanical strength
- Saves time and work force
- Can be applied even at low temperatures

### APPLICATION AREAS

- Anchoring and bonding concrete, marble, stone etc. on perforated-brick and briquette walls
- Machinery & system anchoring and installation works, installation of satellite dish and TV systems
- Fitting radiators and pipe systems, installation of lamps and lighting systems
- Fixing decorative panels on walls & ceilings, installation of kitchen and bathroom cabinets

# YOLDAŞ

ENDÜSTRİ ÜRÜNLERİ  
SANAYİ ve TİCARET A.Ş.

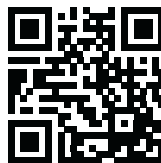

### İSTANBUL HEAD OFFICE

Fettah Başaran cad. No: 89 Orhanlı Tuzla – İstanbul / TURKEY  
Tel : +90 (216) 466 49 49 • Fax : +90 (216) 466 49 50  
e-mail: info@yoldasgrup.com

### İZMİR PLANT

İTOB Osb. 10034 Sk. No:3 Menderes İZMİR / TURKEY

www.yoldasgrup.com